

P.C.B. LAYOUT

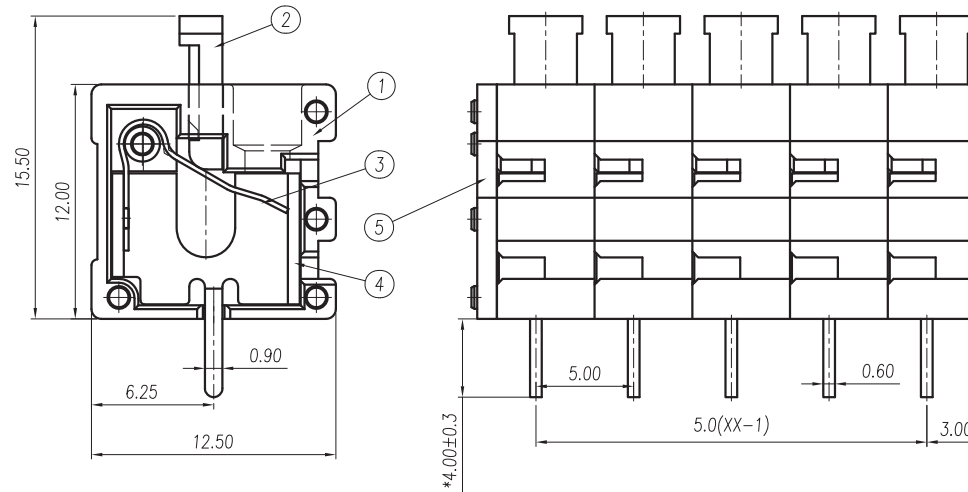

Approvals

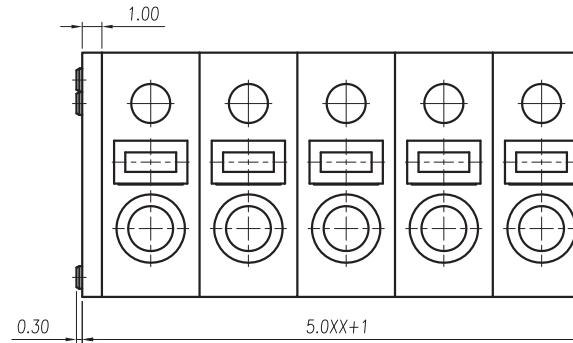

not approved
not approved

Electrical

Rated voltage	250 V
Rated current	15 A
Contact resistance	20Ω
Insulation resistance	500MΩ/DC500V
Withstanding voltage	AC2000V/1 min
Wire range	2,5mm ² 28÷14 AWG
Torque	---
Temp. Range	-40°C + 105°C
Stripping length	11 mm
Max sold. time	+250°C for 5 sec.

Dimensions

Pitch	5.00 mm
Poles	1÷xx

Material

Housing	PA66 UL94V0
Pin	Brass, Tin Plated
Cage	---
Screws	---
Side Block	---
Nut screw	---
Clamp	Stainless Steel

General description of ordering code

Series	n. Poles	Pitch	Version	Color	Custom
MRM8	1÷XX	-5	-V		

Version Date

16/01 25/02/2016



euro-block



UNITS: mm

SHEET SIZE: ISO A4

SCALE: 4:1

> 0 ~ 3

> 3 ~ 18

> 18 ~ 50

> 50 ~ 120

± 0.12

± 0.15

± 0.3

± 0.5



First angle projection

MRM8-5-V