

p.c.b. layout

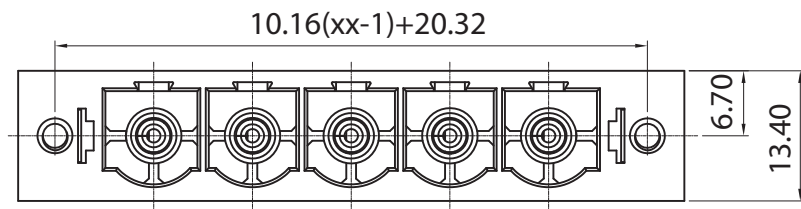

**Approvals**

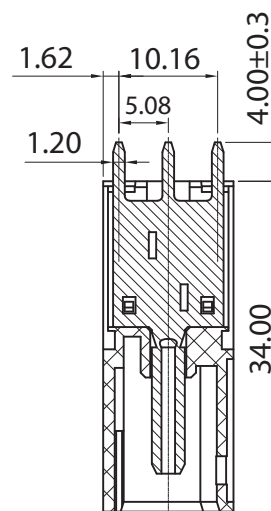
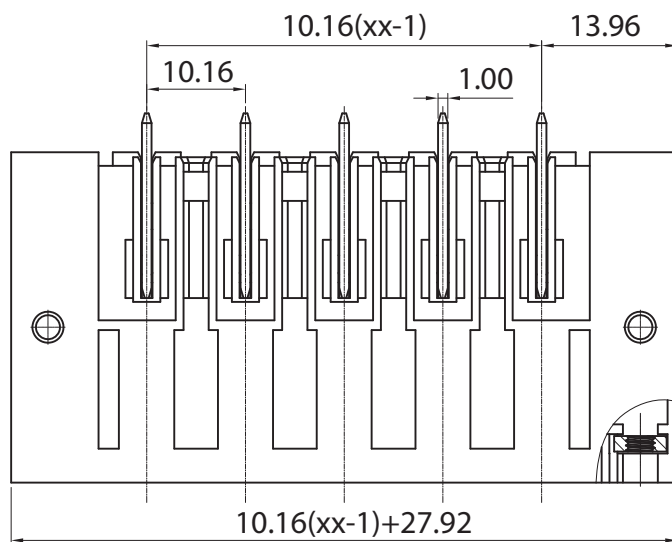

55A-300V  
not approved

**Electrical**

Rated voltage 1000V  
Rated current 76A  
Contact resistance 20mΩ  
Insulation resistance 500MΩ/DC500V  
Withstanding voltage AC3500V/1 min  
Wire range ---

Torque ---  
Temp. Range -40°C + 105°C  
Stripping length ---  
Max sold. time +250°C for 5 sec.

**Dimensions**

Pitch 10.16 mm  
Poles 2±10

**Material**

Housing PA66 UL94V0  
Pin Copper Alloy, Sn plated  
Cage ---  
Screws ---  
Side Block ---  
Nut screw ---  
Clamp ---

**General description of ordering code**

Series	n. Poles	Pitch	Version	Color	Custom
CMP	02±10	-10.16	-VF		

**Version Date**

21/01 17/06/2021



**euro-block**



UNITS: mm

SHEET SIZE: ISO A4

SCALE: 3:2

> 0 ~ 3

> 3 ~ 18

> 18 ~ 50

> 50 ~ 120

± 0.12

± 0.15

± 0.3

± 0.5



First angle projection

**CMP-10.16-VF**