

**P.C.B. LAYOUT**

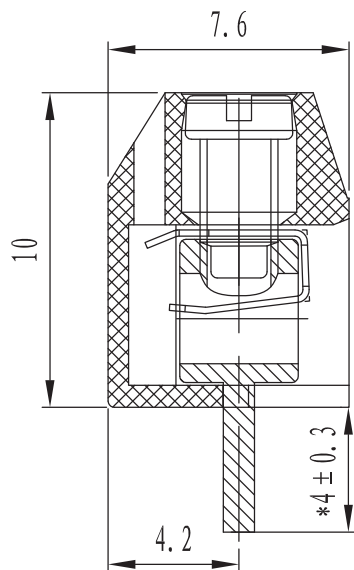

**SECTION A-A**

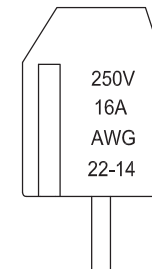
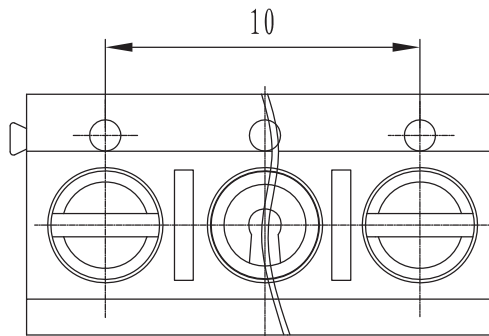
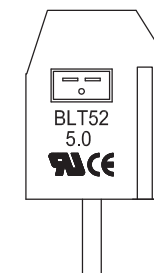
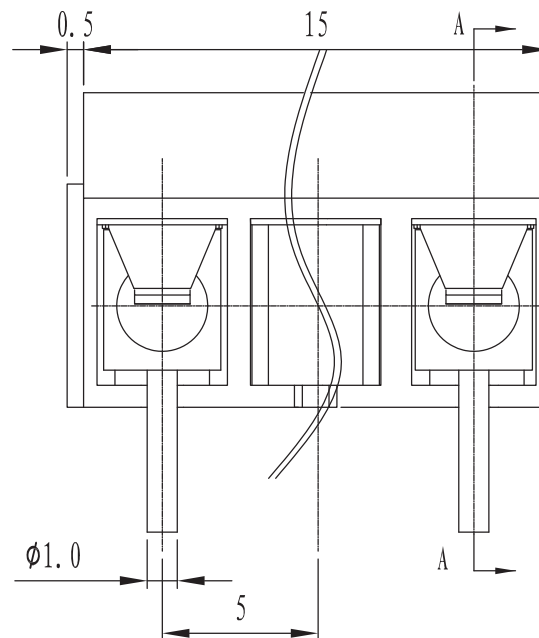

**Approvals**



16A-250V  
not approved

**Electrical**

Rated voltage 250 V  
 Rated current 17,5A  
 Contact resistance 20mΩ  
 Insulation resistance 500MΩ/DC500V  
 Withstanding voltage AC2000V/1 min  
 Wire range 1,5mm2 22÷16 AWG

Torque 0,4Nm (3.6Lb in)  
 Temp. Range -30°C + 120°C  
 Stripping length 5 mm  
 Max sold. time +250°C for 5 sec.

**Dimensions**

Pitch 10 mm  
 Poles 2÷12

**Material**

Housing PA66 UL94V0  
 Pin -  
 Cage Brass, Sn plated  
 Screws M2.5, Steel, Zn plated  
 Side Block -  
 Nut screw -  
 Clamp Phosphore bronze, Ni plated

**General description of ordering code**

Series	n. Poles	Pitch	Version	Color	Custom
BLT52	2÷12	-10	-V	-	-

**Version Date**

15/01 28/04/2015



**euro-block**



**UNITS:** mm

**SHEET SIZE:** ISO A4

**SCALE:** 4:1

> 0 ~ 3  
± 0.12

> 3 ~ 18  
± 0.15

> 18 ~ 50  
± 0.3

> 50 ~ 120  
± 0.5

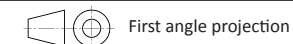

**BLT52-10-V**