

p.c.b. layout

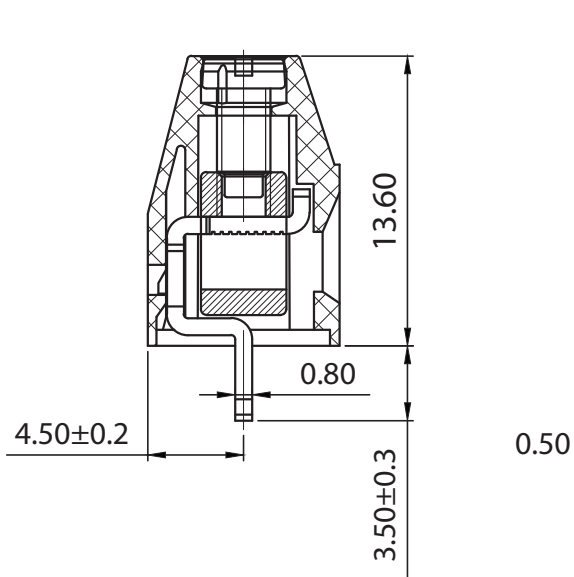

SECTION: A-A

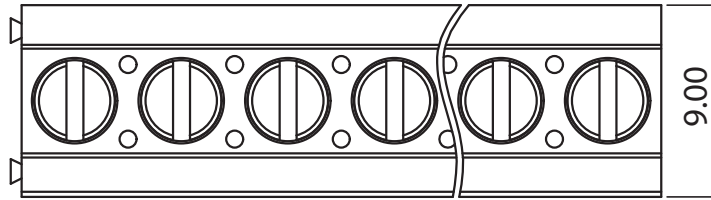
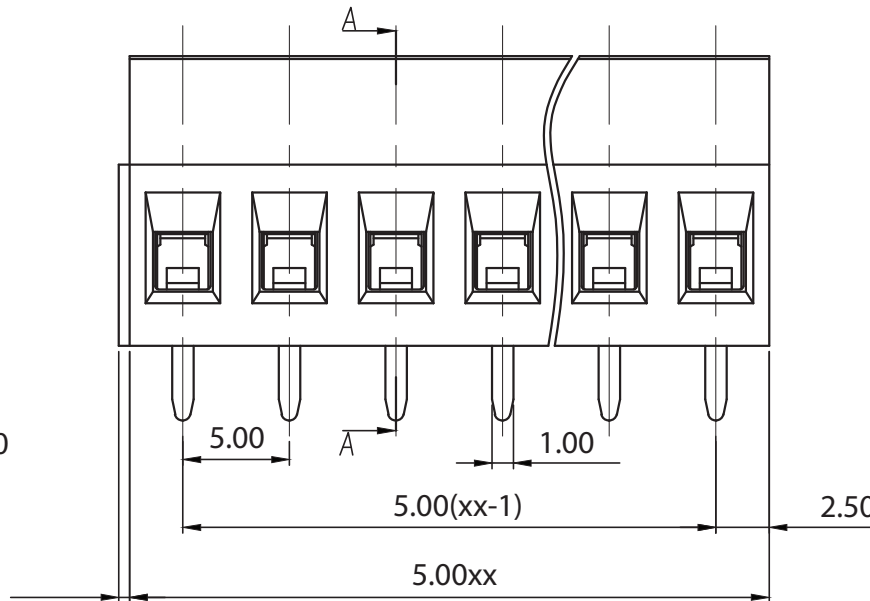

Approvals



16A - 300V

Electrical

Rated voltage	250V
Rated current	18A
Contact resistance	20mΩ
Insulation resistance	500MΩ/DC500V
Withstanding voltage	AC1600V/1 min
Wire range	2,5 mm2 22÷12 AWG

Torque	0,4 Nm(3.6 Lb In.)
Temp. Range	-40°C + 105 °C
Stripping length	6 mm
Max sold. time	+250°C for 5 sec

Dimensions

Pitch	5 mm
Poles	2÷24

Material

Housing	PA66 UL94 V0
Pin	Copper Alloy, Sn plated
Cage	Copper Alloy, Ni plated
Screws	M2.5; Steel, Zn plated
Side Block	
Nut screw	
Clamp	

General description of ordering code

Series	n. Poles	Pitch	Version	Color	Custom
MRC52	2÷24	-5	-V		

Version Date

01/22 19/07/22



euro-block



UNITS: mm

SHEET SIZE: ISO A4

SCALE: 10:1

> 0 ~ 3

> 3 ~ 18

> 18 ~ 50

> 50 ~ 120

± 0.12

± 0.15

± 0.3

± 0.5

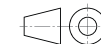

First angle projection

MRC52-5-V