

**Approvals**



15A 300V  
not approved

**Electrical**

Rated voltage 450V  
 Rated current 20A  
 Contact resistance 20mΩ  
 Insulation resistance 500MΩ/DC500V  
 Withstanding voltage AC2000V/ 1min  
 Wire range  
  
 Torque  
 Temp. Range -40°C + 105°C  
 Stripping length  
 Max sold. time +250°C for 5 sec

**Dimensions**

Pitch 5 mm  
 Poles 2÷24

**Material**

Housing PA66 UL94V0  
 Pin Copper Alloy, tin plated  
 Cage  
 Screws  
 Side Block  
 Nut screw  
 Clamp

**General description of ordering code**

Series	n. Poles	Pitch	Version	Color	Custom
CMP1	02÷24	-5	-VP		

**Version** 01/17  
**Date** 27/10/17

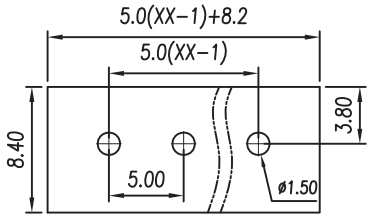

**P.C.B. LAYOUT**

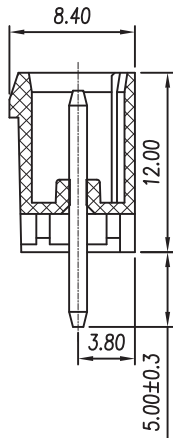
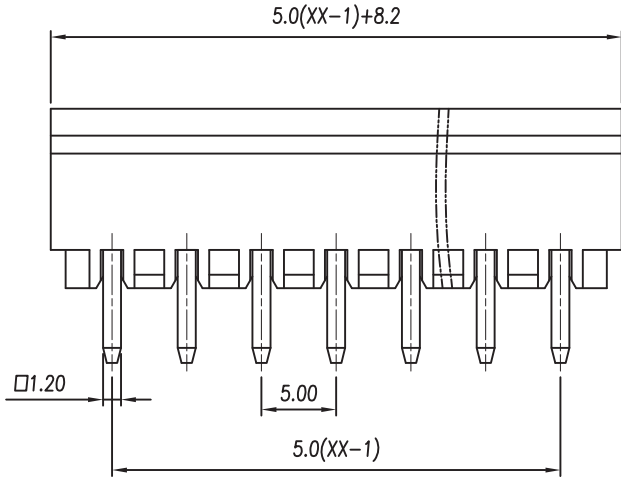
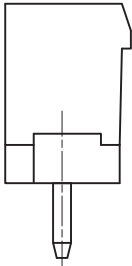
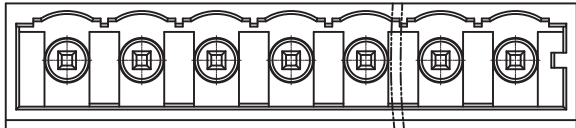

**euro-block**



**UNITS:** mm

**SHEET SIZE:** ISO A4

**SCALE:** 10:1

> 0 ~ 3	> 3 ~ 18	> 18 ~ 50	> 50 ~ 120
± 0.12	± 0.15	± 0.3	± 0.5

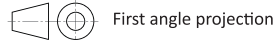

**CMP1-5-VP**